

MiTek USA, Inc.



Nailing Pattern		
L-Brace size	Nail Size	Nail Spacing
1x4 or 6	10d (0.131" X 3")	8" o.c.
2x4, 6, or 8	16d (0.131" X 3.5")	8" o.c.

Note: Nail along entire length of L-Brace  
(On Two-Ply's Nail to Both Plies)

Note: L-Bracing to be used when continuous lateral bracing is impractical. L-brace must cover 90% of web length.

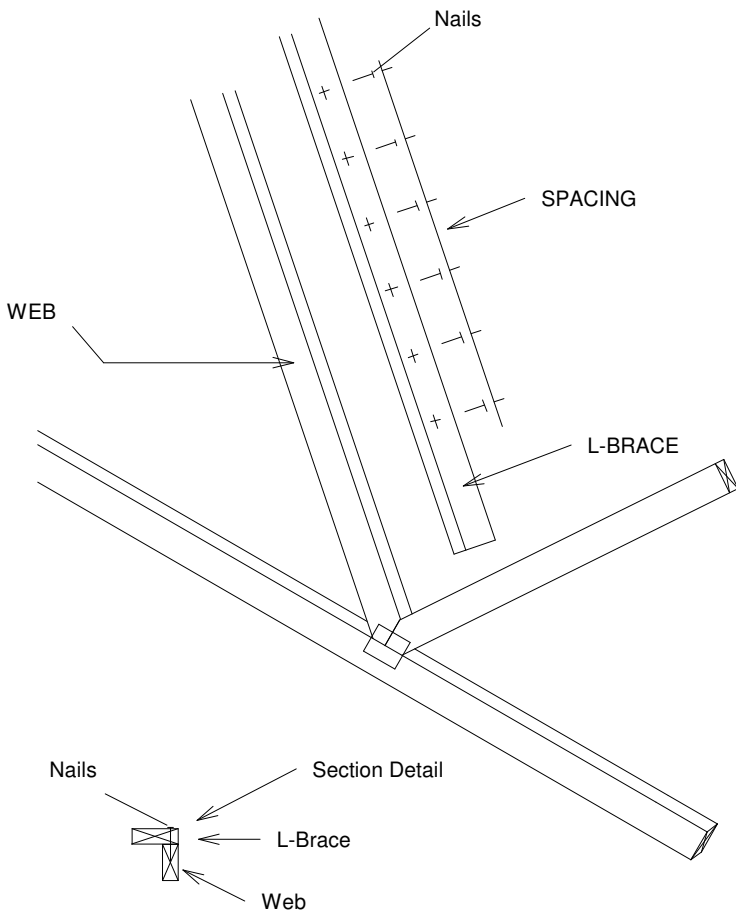

L-Brace Size for One-Ply Truss

Web Size	Specified Continuous Rows of Lateral Bracing	
	1	2
2x3 or 2x4	1x4	***
2x6	1x6	***
2x8	2x8	***

\*\*\* DIRECT SUBSTITUTION NOT APPLICABLE.

L-Brace Size for Two-Ply Truss

Web Size	Specified Continuous Rows of Lateral Bracing	
	1	2
2x3 or 2x4	2x4	***
2x6	2x6	***
2x8	2x8	***

\*\*\* DIRECT SUBSTITUTION NOT APPLICABLE.

L-Brace must be same species grade (or better) as web member.